

ABOUT A TABLE 20

DESIGN BY HEE WELLING & HAY



The About A Table shares the general versatility and design language with the rest of the family. The table features the same powder coated frame as many of the chairs in the series, and the organic curves and raised feet convey a similar light expression. The tables are available with round (AAT 20), square (AAT 15) or rectangular (AAT 10) tabletops, with the round and square tabletop resting on a centred frame, while the rectangular version has its legs positioned at both ends and has a cross-bar construction. About A Table is available in two heights and a wide range of dimensions, enabling you to create a unique solution to match your needs.

PRODUCT DETAILS

- / Part of a multi-functional family of dining and conference chairs, office chairs, bar stools, lounge chairs, tables, an ottoman and a sofa.
- / Suitable for a wide variety of private and public environments.
- / Qualified for contract use.
- / The table is available with square (AAT 15), rectangular (AAT 10) and round (AAT 20) tabletops.

HAY

MATERIAL

TABLETOP / 22 mm plywood tabletop with linoleum or laminate with rounded edges.

FRAME / 3 or 4 legs in powder coated or polished aluminium.

COLOUR & FINISH

Please note that the colour codes are indicative.

TABLETOP / Available in 2 different colours.

/ Black linoleum with black stained plywood edges
(Forbo Desktop Nero 4023).

/ White laminate with raw plywood edges
(Formica Blanc Polaire F2274).

FRAME FINISH / Available in 2 different base finishes.

/ Black powder coated aluminium (RAL 9005)

/ White powder coated aluminium (RAL 9003)

/ Polished aluminium

CONSTRUCTION

TABLETOP / in 22 mm plywood with rounded edges.

FRAME / Is made of extruded profiles and diecast aluminium parts. The frame parts are fastened and locked with expansion elements and steel reinforcement brackets. The tabletop is mounted with self-tapping screws in predrilled holes.

Requires assembly.

TABLETOP COLOUR

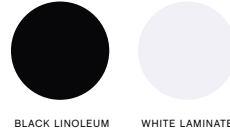

FRAME FINISH

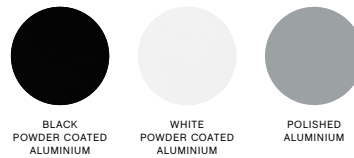

DIMENSIONS

DIAMETER / 80 cm / 31.50"
HEIGHT / 73 cm / 28.74"

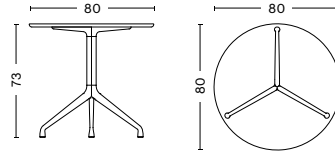

DIAMETER / 100 cm / 39.37"
HEIGHT / 73 cm / 28.74"

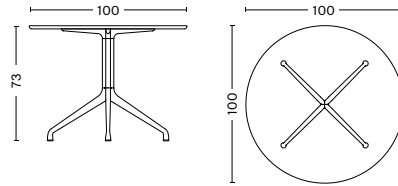

DIAMETER / 110 cm / 43.31"
HEIGHT / 73 cm / 28.74"

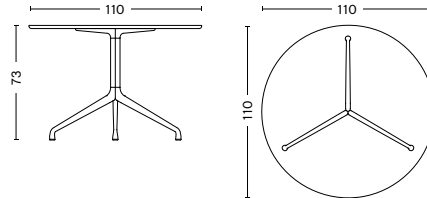

DIAMETER / 128 cm / 50.39"
HEIGHT / 73 cm / 28.74"

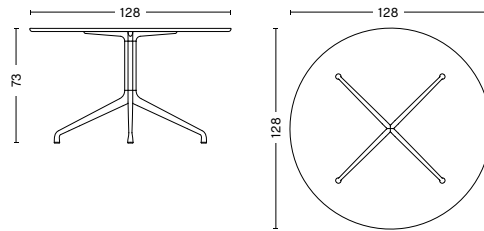

DIAMETER / 80 cm / 31.50"
HEIGHT / 105 cm / 41.34"

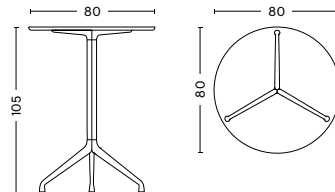

TESTS

4 legged tables AAT20 Ø128 and Ø100 / EN 15372: 2008 /
Furniture - Strength, durability and safety - Requirements for
non-domestic tables.
L3: Severe use.

DOWNLOADS

2D files, 3D files and packshots are available in our imagebank
at hay.com.

Care- and maintenance instructions and test certificates are
available at hay.com.