

**BALL LIGHT  
SMALL WALL MOUNTED, 2009**

Polished Brass.

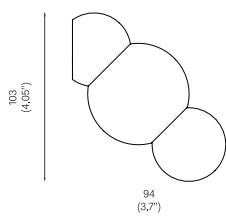

**OVERALL DIMENSIONS**



**BACKPLATE DIMENSIONS**

Mounting screws not included  
5mm countersunk screw recommended

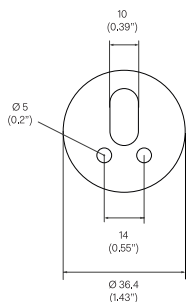

**MATERIALS AND FINISHES**



MA-BLS-WM-PBR  
Polished Brass

**BULB SPECIFICATIONS**

G9 2W LED Bulb  
250lm / 2700K

**PRODUCT SPECIFICATIONS**

Input voltage: 120V / 240V  
Maximum wattage: 5W  
120V / 240V dimmable LED triac  
Product weight: 1kg

120V version supplied with paintable junction box cover.

**CLEANING INSTRUCTIONS**

Before cleaning, lighting fixtures must be turned off and unplugged from mains electricity. Whilst cleaning please take care and use the gloves provided.

Polished brass: As the item is unlacquered it will naturally oxidise and darken. Upon touching the items without gloves, fingerprints are likely to occur and leave marks. Use a good quality brass cleaning liquid and follow the product instructions using the extra soft dust cloth. Do not apply pressure on persistent marks. Remove them using repeated gentle motions and by reapplying the brass cleaning liquid.

Opaline Glass: Remove the opaline glass from the product. Using a lightly damp cloth, clean only the outside of the sphere. Only put the glass sphere back on the product once it is fully dry.



**BALL LIGHT  
LARGE WALL MOUNTED, 2009**

Polished Brass.



**OVERALL DIMENSIONS**

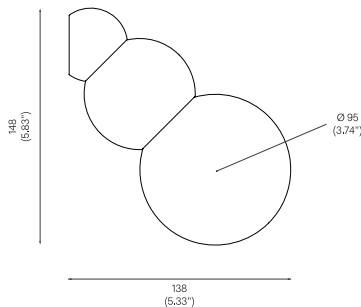

**BACKPLATE DIMENSIONS**

Mounting screws not included  
5mm countersunk screw recommended

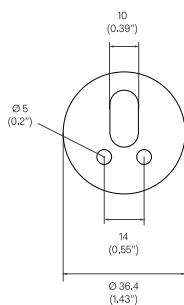

**MATERIALS AND FINISHES**



MA-BLL-WM-PBR  
Polished Brass

**BULB SPECIFICATIONS**

G9 3.5W LED bulb  
330 lm / 2700K

**PRODUCT SPECIFICATIONS**

Input voltage: 120V / 240V  
Maximum wattage: 20W  
120V / 240V dimmable LED triac  
Product weight: 2kg

120V version supplied with paintable junction  
box cover.

**CLEANING INSTRUCTIONS**

Before cleaning, lighting fixtures must be turned off and unplugged from mains electricity. Whilst cleaning please take care and use the gloves provided.

Polished brass: As the item is unlacquered it will naturally oxidise and darken. Upon touching the items without gloves, fingerprints are likely to occur and leave marks. Use a good quality brass cleaning liquid and follow the product instructions using the extra soft dust cloth. Do not apply pressure on persistent marks. Remove them using repeated gentle motions and by reapplying the brass cleaning liquid.

Opaline Glass: Remove the opaline glass from the product. Using a lightly damp cloth, clean only the outside of the sphere. Only put the glass sphere back on the product once it is fully dry.