

- PENDANTS: one
- MOUNTING: white powder coated metal mounting plate 55mm (2.2") in diameter
- LAMPING: 1.5w LED or 10w xenon
- INSTALLATION: threaded on - wall or ceiling mount
- MATERIALS: cast glass, electrical components, metal mounting plate
- WEIGHT: approximately 1kg (2lb)
- POWER SUPPLIES: remote mounted.

DESCRIPTION

The 's' designation in this variation on the 14 refers to it being surface-mounted, with power supplies mounted remotely. This surface light has a discrete 55mm (2.2") mounting plate designed for installation on walls or ceilings. It is also IP65 designated meaning that the 14s can be used outdoors and in other wet environments.

The 14s is an articulated, seamed cast glass hemisphere with a frosted cylindrical void that houses a low voltage lamp. Individual pendants are visually quite subtle, but gain tremendous strength when multiplied and clustered in large groups.

NOTES

- + Purchase replacement lamps online at www.bocci.ca/shop/bulbs
- + Unless otherwise noted when ordering, all chandeliers will be outfitted to be xenon compatible.
- + Unless otherwise specified, a single class 2 transformer will be sent for every 5 xenon fixtures or every 12 LED fixtures

US Patent # D556, 361
EU Patent # 000518394-0001

Made in Vancouver, Canada

Vancouver
sales@bocci.ca
www.bocci.ca

Berlin
europe@bocci.ca
www.bocci.ca

approx 1kg (2lb)



SURFACE LIGHT

14s

Design by Omer Arbel
PRODUCT SPECIFICATION

© 2019, Bocci Design and Manufacturing Inc. All rights reserved. Any inquiries should be directed to: info@bocci.ca

BOCCI

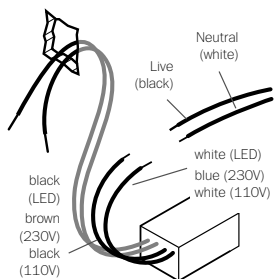

1

Mount power supply remotely and route output wiring from power supply to surface mounted light location.

Xenon (110V) or LED: connect the black wire to live wire and white wire to neutral wire.

Xenon (230V): connect black wire to brown wire and white wire to blue wire.

Note: Standard junction boxes are not compatible with the 84s. The surface mounted light cover plate mounts directly to the wall. Power supplies must be remote mounted in a close by, accessible and hidden location for ease of long term maintenance. Installation to be done by certified personnel to ensure code compliance.

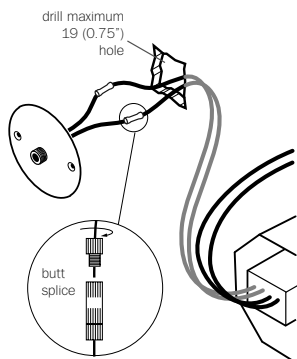

2

Drill a maximum 19mm (0.75") diameter hole.

Join power supply wiring to back plate wiring using #16 butt splices, provided (stagger the splices).

Tuck wiring into wall opening and affix the back plate with fasteners provided.

Stagger the provided connectors so that they can be passed through the hole.

Turn power to fixture on.

DRY LOCATION

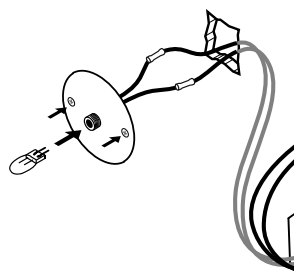

3

For dry location:

Insert provided lamp into socket. Check that each lamp is working properly as you go along by keeping the power on.

Note: when using a dimmer use only low voltage electronic dimmer.

WET LOCATION

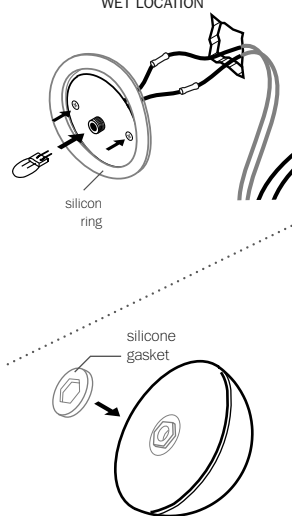

4

For wet location:

Insert provided lamp into socket. Check that each lamp is working properly as you go along by keeping the power on.

Install the silicone ring by slightly stretching it to fit around the back plate.

Note: when using a dimmer use only low voltage electronic dimmer.

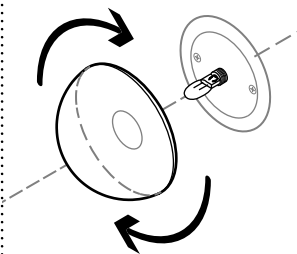

5

Gently thread cast glass hemisphere onto cover plate. Do not tighten past the point of contact.

6

Clean fingerprints from surfaces.

For additional assistance, please contact Bocci:

Vancouver
sales@bocci.ca
www.bocci.ca

Berlin
europe@bocci.ca
www.bocci.ca

US Patent # D556, 361
EU Patent # 000518394-0001

Made in Vancouver, Canada



SURFACE LIGHT

14s

Design by Omer Arbel
PRODUCT INSTALLATION INSTRUCTIONS

© 2019, Bocci Design and Manufacturing Inc. All rights reserved. Any inquiries should be directed to: info@bocci.ca

BOCCI